



**Illustrated Parts Catalog
(Cray SV1™ and SuperCluster® Series)**

108-0204-002

SGI Private

Any shipment to a country outside of the United States requires a
letter of assurance from Silicon Graphics, Inc.

This document is the property of Silicon Graphics, Inc. The use of this document is subject to specific license rights extended by Silicon Graphics, Inc. to the owner or lessee of a Silicon Graphics, Inc. computer system or other licensed party according to the terms and conditions of the license and for no other purpose.

Silicon Graphics, Inc. Unpublished Private Information — All Rights Reserved.

Autotasking, CF77, Cray, Cray-1, Cray Ada, CraySoft, Cray Y-MP, CRInform, CRI/TurboKiva, HSX, LibSci, MPP Apprentice, SSD, SuperCluster, UNICOS, and X-MP EA are federally registered trademarks and Because no workstation is an island, CCI, CCMT, CF90, CFT, CFT2, CFT77, ConCurrent Maintenance Tools, COS, Cray-2, Cray Animation Theater, Cray APP, Cray C90, Cray C90D, Cray C++ Compiling System, CrayDoc, Cray EL, Cray J90, Cray J90se, CrayLink, Cray NQS, Cray/REELlibrarian, Cray S-MP, Cray SSD-T90, Cray SV1, Cray T3D, Cray T3E, Cray T3E-900, Cray T90, CrayTutor, Cray X-MP, Cray XMS, CSIM, CVT, Delivering the power . . . , DGauss, Docview, EMDS, GigaRing, HEXAR, IOS, ND Series Network Disk Array, Network Queuing Environment, Network Queuing Tools, OLNET, RQS, SEGLDR, SMARTE, SUPERLINK, System Maintenance and Remote Testing Environment, Trusted UNICOS, UNICOS MAX, and UNICOS/mk are trademarks of Cray Research, L.L.C., a wholly owned subsidiary of Silicon Graphics, Inc.

O2 and Silicon Graphics are registered trademarks and Origin, SGI, and the SGI logo are trademarks of Silicon Graphics, Inc.

EtherLite is a trademark of Digi International. All other trademarks are the property of their respective owners.

Direct requests for copies of service publications to:

Web site: <http://servinfo.csd.sgi.com>

SGI Customer Service - Logistics
1100 Lowater Road
P. O. Box 4000
Chippewa Falls, WI 54729-0078
USA

Direct comments about this publication to:

E-mail: spt@sgi.com

SGI Customer Service
Service Publications and Training
890 Industrial Blvd.
P.O. Box 4000
Chippewa Falls, WI 54729-0078
USA

Illustrated Parts Catalog

108-0204-002

Cray SV1™ and SuperCluster® Series

Last Modified: October 1999

Introduction **3**

Record of Revision	4
Notational Conventions	4
Cray SV1-1A Panels	5
Cray SV1-1 Panels	6
Cray SV1 SuperCluster Panels	7
Hardware	8
Bezel	9

Cray SV1-1A Mainframe Cabinet **10**

Central Control Unit	11
Input Air Filter	12
CPU Card Cage	13
Front-end Power Chassis	14
Backplane	15
Processor Module	16
Memory Module	17
AC Power Entry Chassis	18
Blower Assembly	19

Cray SV1-1 Mainframe Cabinet **20**

Central Control Unit	21
Input Air Filter	22
CPU Card Cage	23
Front-end Power Chassis	24
Clock Module	25
Processor Module	26

Memory Module	27
AC Power Entry Chassis	28
Blower Assembly	29
System Support	30
O2 Workstation	31
EtherLite Serial Port Server	32
Ethernet Cables	32
Monitor and Keyboard	33
Monitor Cables	33

Introduction

The Cray SV1 series of computer systems may be serviced by properly trained Silicon Graphics, Inc. (SGI) service personnel, customer service personnel, or third-party maintainers. The purpose of this illustrated parts catalog is to assist service personnel in identifying the part numbers of parts they might need to replace.

This catalog describes the major components, or field-replaceable units, of the Cray SV1 and SuperCluster systems. The *Field Replacement Procedures*, publication number 108-0203-001, describes major component removal and replacement procedures. You can access this *Illustrated Parts Catalog* and the *Field Replacement Procedures* on the Worldwide Web at the following URL: <http://spt.cray.com/servinfo/sv1>. You can also access the Cray SV1 Spares Support Plan, which lists the hardware maintenance tools and miscellaneous supplies and their part numbers, on the Worldwide Web at the following URL: <http://www.csd.sgi.com/spo/crispares.html>. You can also access the Spares Support Plan on hydra at [/home/hydra/spe/spares](http://home/hydra/spe/spares); the filename is `sv1.html`.

The parts ordering system ensures shipment of the most up-to-date parts. When you order parts using the part numbers in this catalog, you can be assured that you will receive the latest versions of the parts even if the part numbers have changed.

Note: Refer to the *Illustrated Parts Catalog (PC-10 Cabinet)*, publication number HMM-218-0, for field replaceable parts that are located in the PC-10 cabinet.

Record of Revision

April 1999

Original printing.

October 1999

This revision adds the Cray SV1 SuperCluster panel part numbers. It also adds parts information for the O2 system workstation and EtherLite serial port server. Part numbers were updated for the Cray SV1-1A and Cray SV1-1 system front panels and bezel. Also updated were part numbers for the processor modules and cables for the central control units that the Cray SV1-1A and Cray SV1-1 systems use.

Notational Conventions

Cray SV1-1A and Cray SV1-1 systems share some components. To help clarify part usage, the part-description tables in this catalog contain **Where Used** columns that list the system types where the components are used. From this point on, the mainframe cabinet types are abbreviated as follows:

- SV1-1A designates a Cray SV1-1A system (4 x 4 backplane)
- SV1-1 designates a Cray SV1-1 system (8 x 8 midplane)
- SuperCluster designates a Cray SV1-4, SV1-8, SV1-16, or SV1-32 SuperCluster system (8 x 8 midplane)

Cray SV1-1A Panels

Ref. No.	Part Number	Description	Where Used
1	90539400	Bezel	SV1-1A
2	90524001	Front Panel Assembly with Bezel	SV1-1A
	90510701	Front Panel Assembly without Bezel	SV1-1A
3	90509400	Exhaust Panel Assembly	SV1-1A
4	90524500	Grille Assembly	SV1-1A
5	90371000	Side Trim Panel	SV1-1A, SV1-1
6	90515100	Rear Panel Assembly	SV1-1A

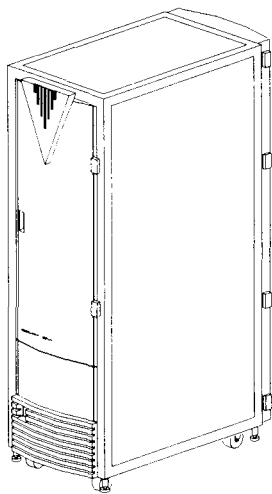

Front View

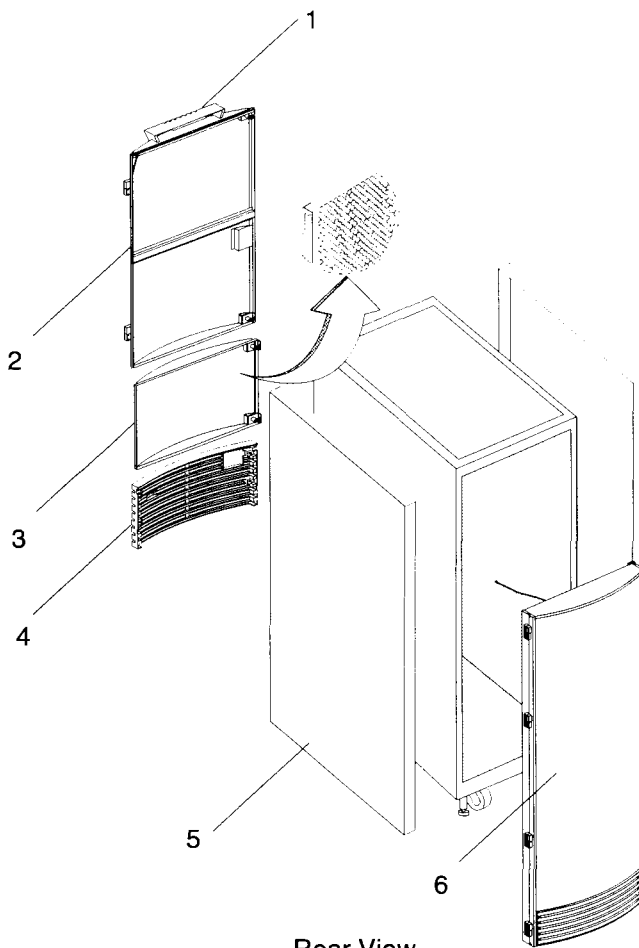

Rear View

Note: A Cray SV1-1A system is shown.

Cray SV1-1 Panels

Ref. No.	Part Number	Description	Where Used
1	90539200	Bezel	SV1-1
2	90523901	Front Panel Assembly with Bezel	SV1-1
	90510801	Front Panel Assembly without Bezel	SV1-1
3	90510500	Exhaust Panel Assembly	SV1-1
4	90524200	Grille Assembly	SV1-1
5	90426700	Side Trim Panel	SV1-1
6	90371000	Side Trim Panel	SV1-1A, SV1-1
7	90515000	Rear Panel Assembly	SV1-1

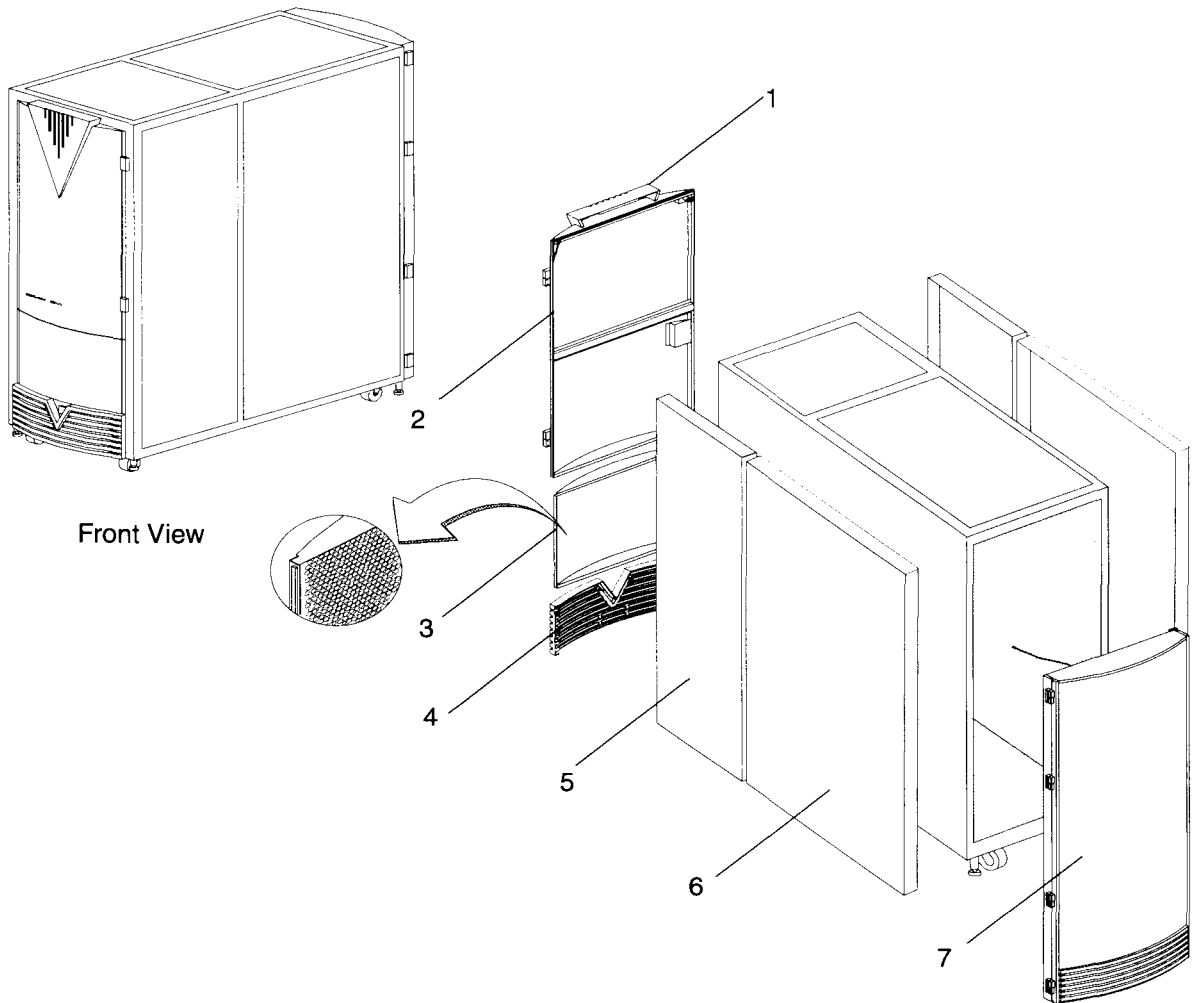

Note: A Cray SV1-1 system is shown.

Rear View

Cray SV1 SuperCluster Panels

Ref. No.	Part Number	Description	Where Used
1	90518400	Seat	SuperCluster
2	90517800	Bulkhead Cover Panel	SuperCluster
3	90517400	Skirt, Trim Panel	SuperCluster

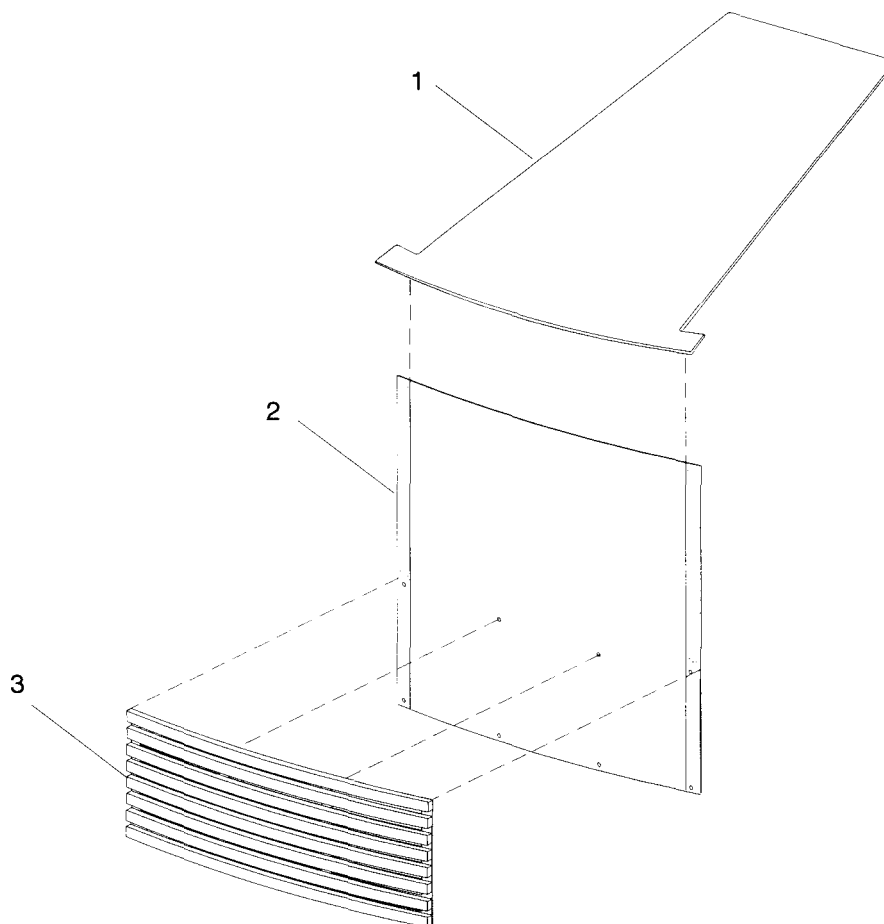

Hardware

Ref. No.	Part Number	Description	Where Used
1	90395101	Cable Assembly Ground, Front Door	SV1-1A
	90395100	Cable Assembly Ground, Front Door	SV1-1
2	90365700	Latch	SV1-1A, SV1-1
3	90347200	Bar Latch	SV1-1A, SV1-1
4	90399600	Caster	SV1-1A
	90377500	Caster	SV1-1
5	90377600	Leveler	SV1-1A, SV1-1
6	90385200	Cable Assembly Ground, Rear Door	SV1-1A, SV1-1
7	90346901	Offset Lift-off Hinge, Front Door	SV1-1A, SV1-1
	90346900	Offset Lift-off Hinge, Rear Door	SV1-1A, SV1-1

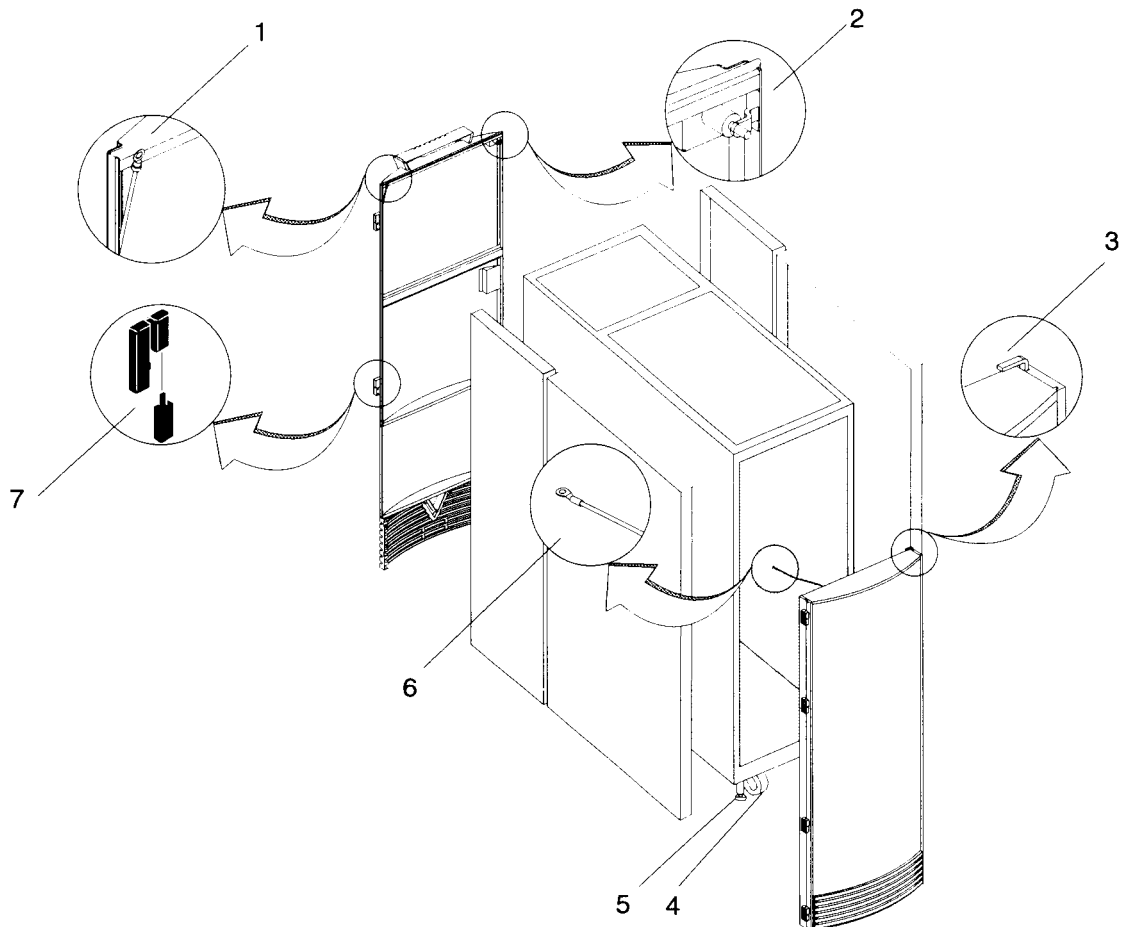

Rear View

Bezel

Ref. No.	Part Number	Description	Where Used
1	90523800	PCB Assembly, LED	SV1-1A
	90523200	PCB Assembly, LED	SV1-1
2	90539400	Bezel	SV1-1A
	90539200	Bezel	SV1-1
3	90526000	LED Board Cable Assembly	SV1-1A, SV1-1

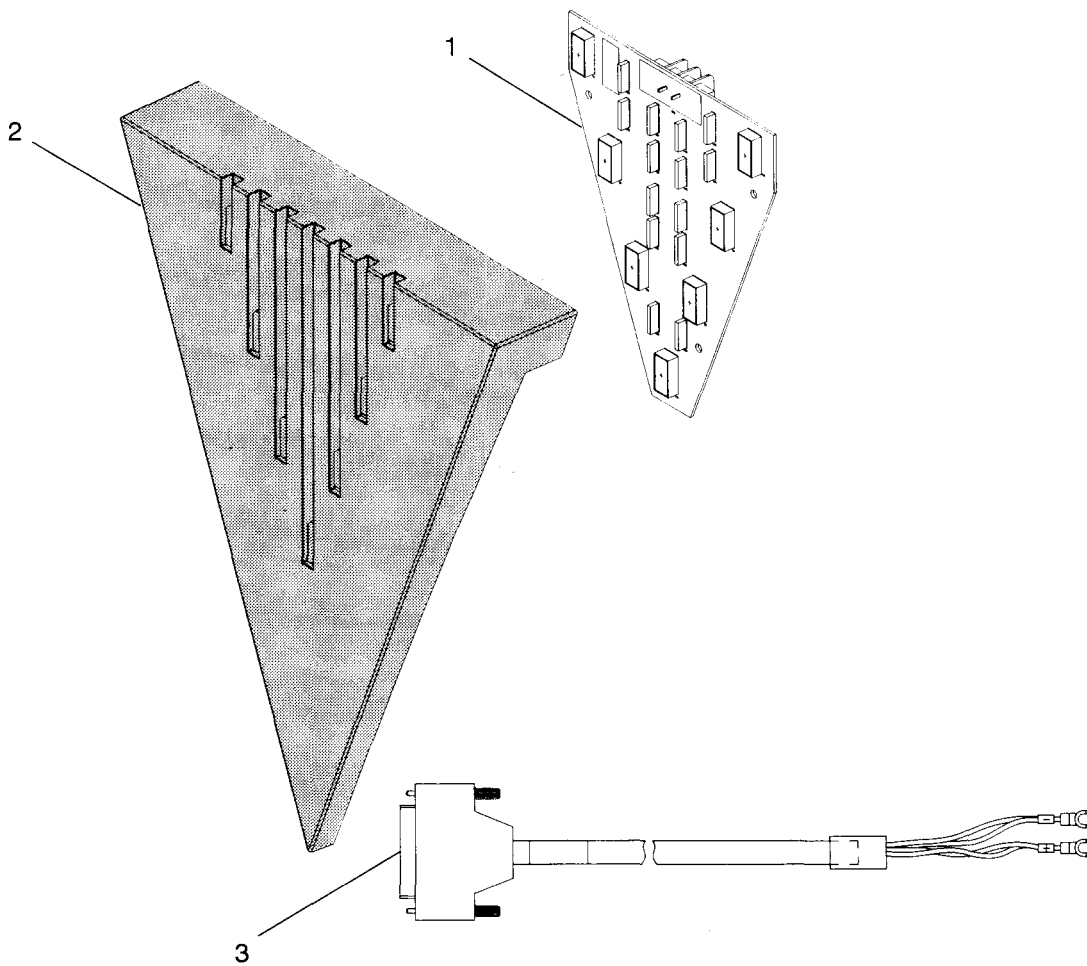

Cray SV1-1A Mainframe Cabinet

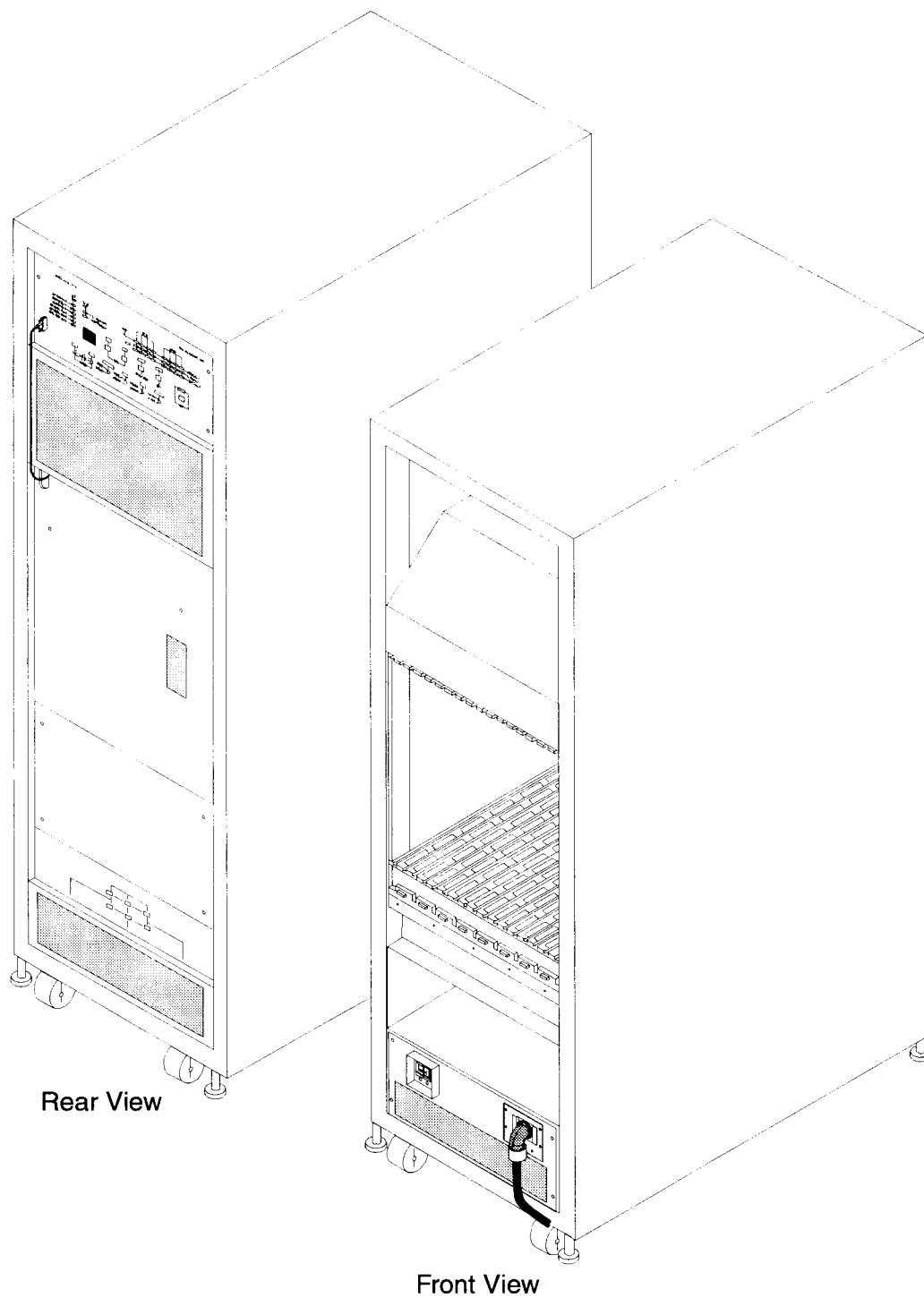

Central Control Unit

Ref. No.	Part Number	Description	Where Used
1	90472400	Central Control Unit with Remote RS-232	SV1-1A
2	90526300	CCU to Bezel Cable	SV1-1A, SV1-1
3	90350000	CCU to Card Cage Backplane Sense Cable	SV1-1A
4	90350200	CCU to Front-end Power Sense Cable	SV1-1A
5	90350300	CCU to AC Power Entry Sense Cable	SV1-1A
6	90350600	Alarm Cable	SV1-1A, SV1-1
7	90472300	CCU to RS-232 Remote Cable	SV1-1A, SV1-1
8	90537900	Serial Port EL-16 Cable	SV1-1A, SV1-1
9	13309000	Adapter, WACS RJ45-DB25	SV1-1A, SV1-1
10	90454000	Battery, 1.2 V	SV1-1A (qty. 4), SV1-1 (qty. 8)

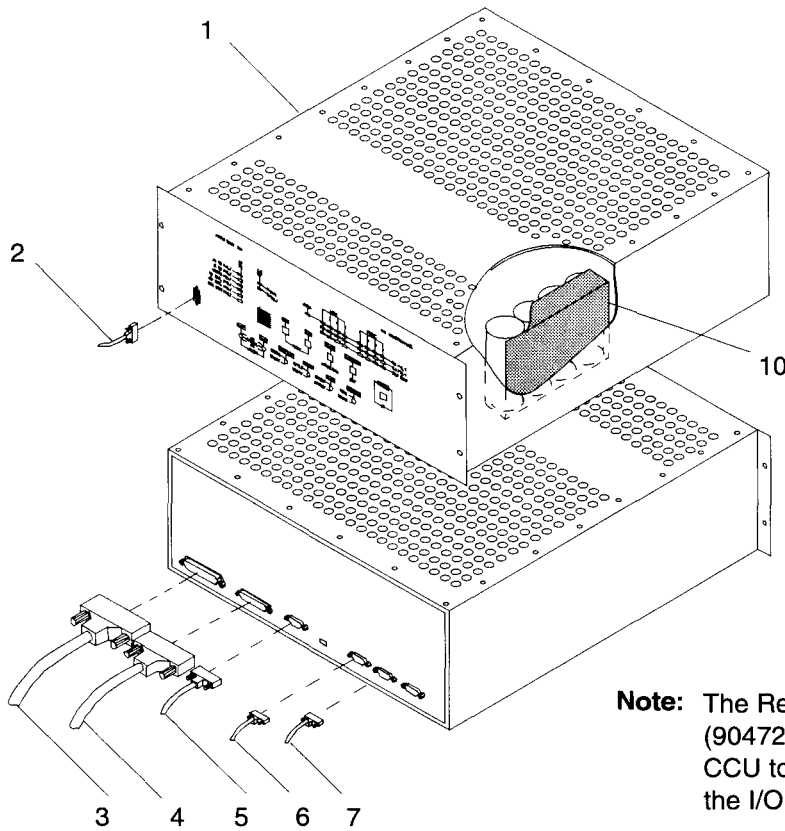

Note: The Remote CCU to SWS Cable (90472300) is used to connect the CCU to the RS-232 remote cable at the I/O bulkhead.

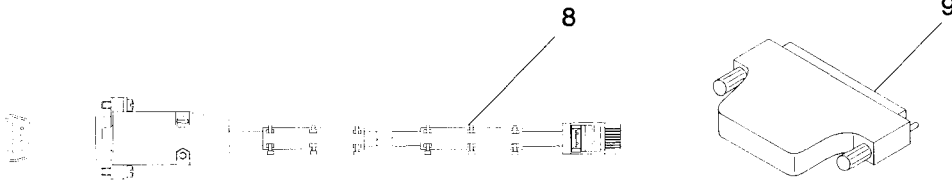

Input Air Filter

Ref. No.	Part Number	Description	Where Used
1	90312400	Input Air Filter	SV1-1A (qty.1), SV1-1 (qty. 2)

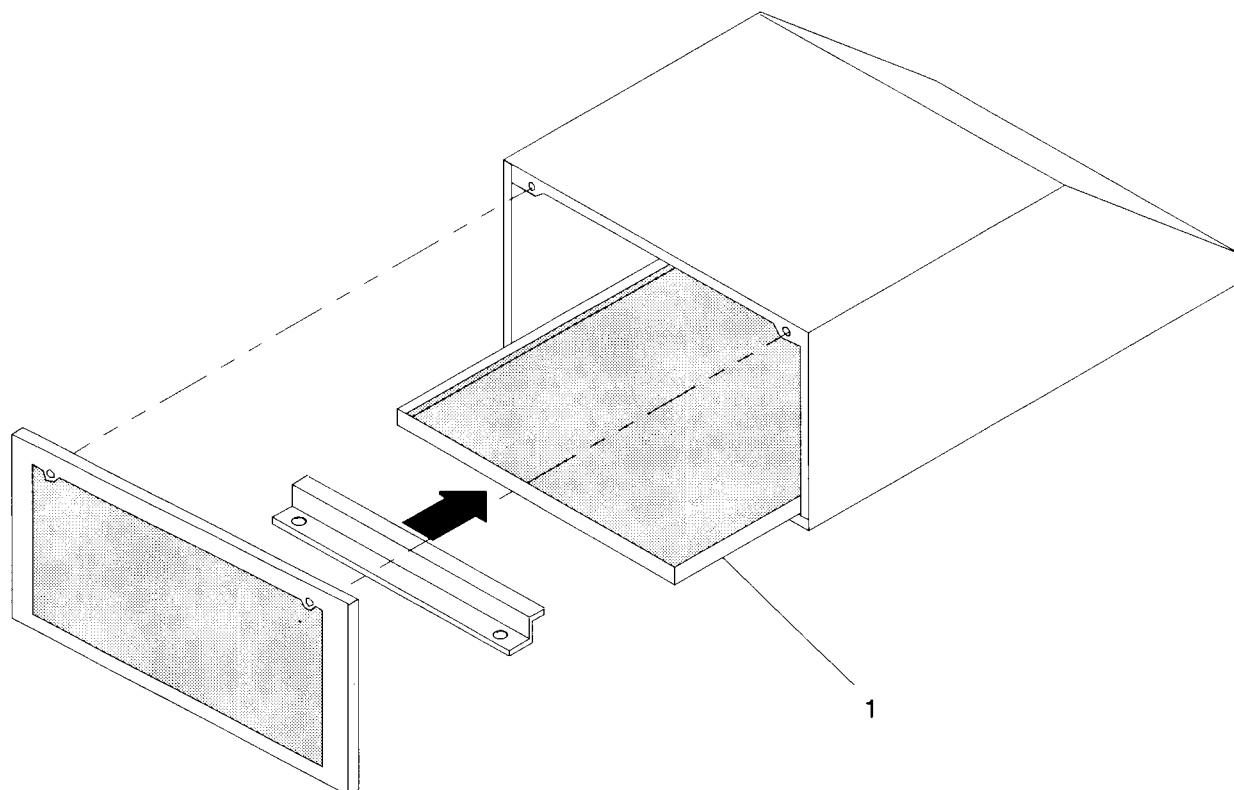

CPU Card Cage

Ref. No.	Part Number	Description	Where Used
1	90343611	Enable Plug	SV1-1A, SV1 Upgrade Kit
2	90350200	Sense Cable	SV1-1A
	90350201	Sense Cable	SV1-1
3	90536200	Clock Module	SV1-1A

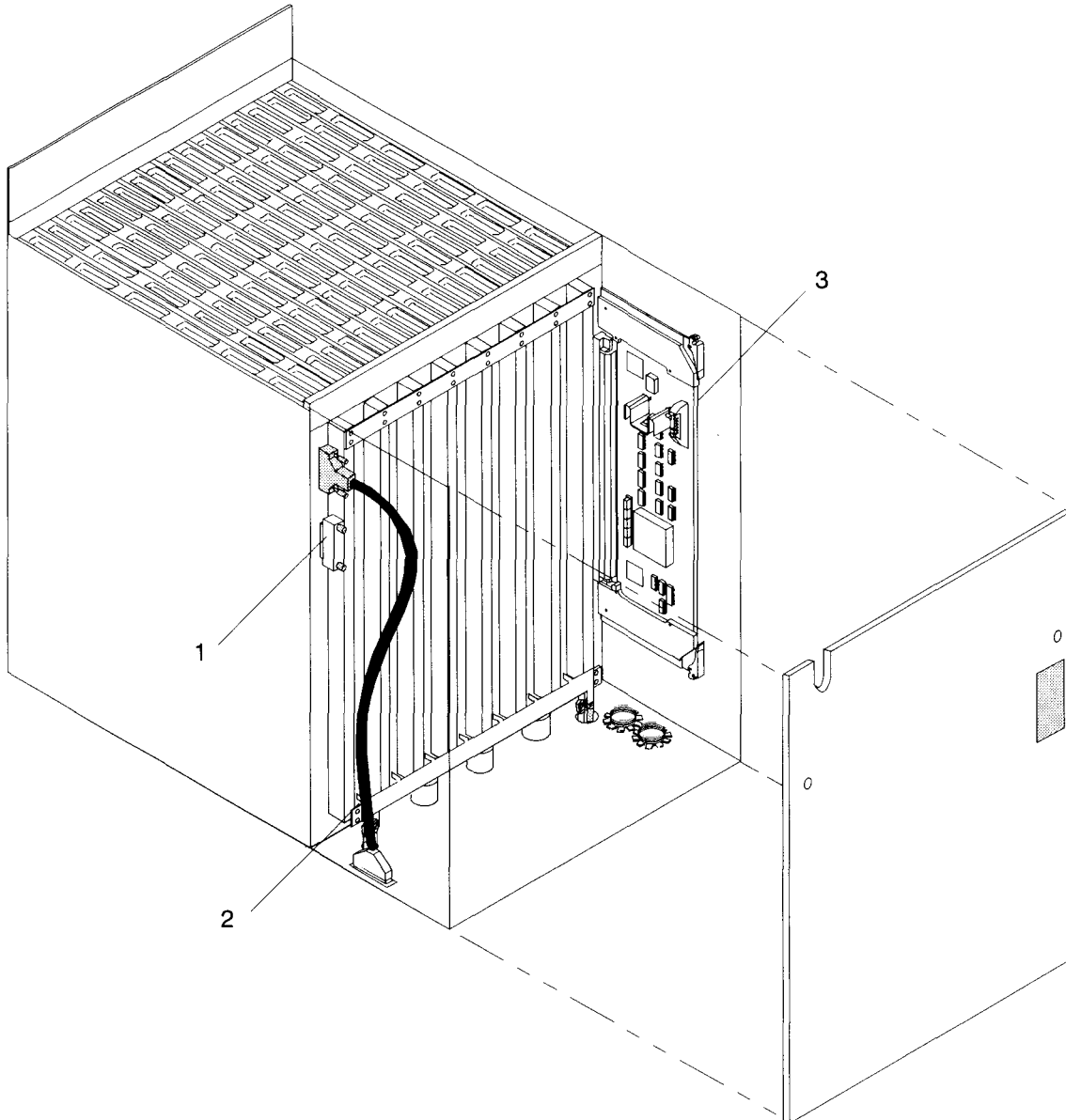

Front-end Power Chassis

Ref. No.	Part Number	Description	Where Used
1	90307101	Power Cord, 1 m	SV1-1A, SV1-1
2	90459600	Fuse, 10 A	SV1-1A, SV1-1
3	90327900	220 Vac/48 Vdc Power Supply	SV1-1A, SV1-1
4	90365200	Power Supply Air Filter	SV1-1A
5	90375700	Front-end Power Chassis	SV1-1A
6	01134006	Fuse, 1/2 A	SV1-1A, SV1-1
7	90360500	Front-end to CPU Backplane Cable, 48 V	SV1-1A
8	90350400	Front-end Power Chassis to Blower Assembly Sense Cable	SV1-1A, SV1-1
9	90350200	CCU to Front-end Power Sense Cable	SV1-1A

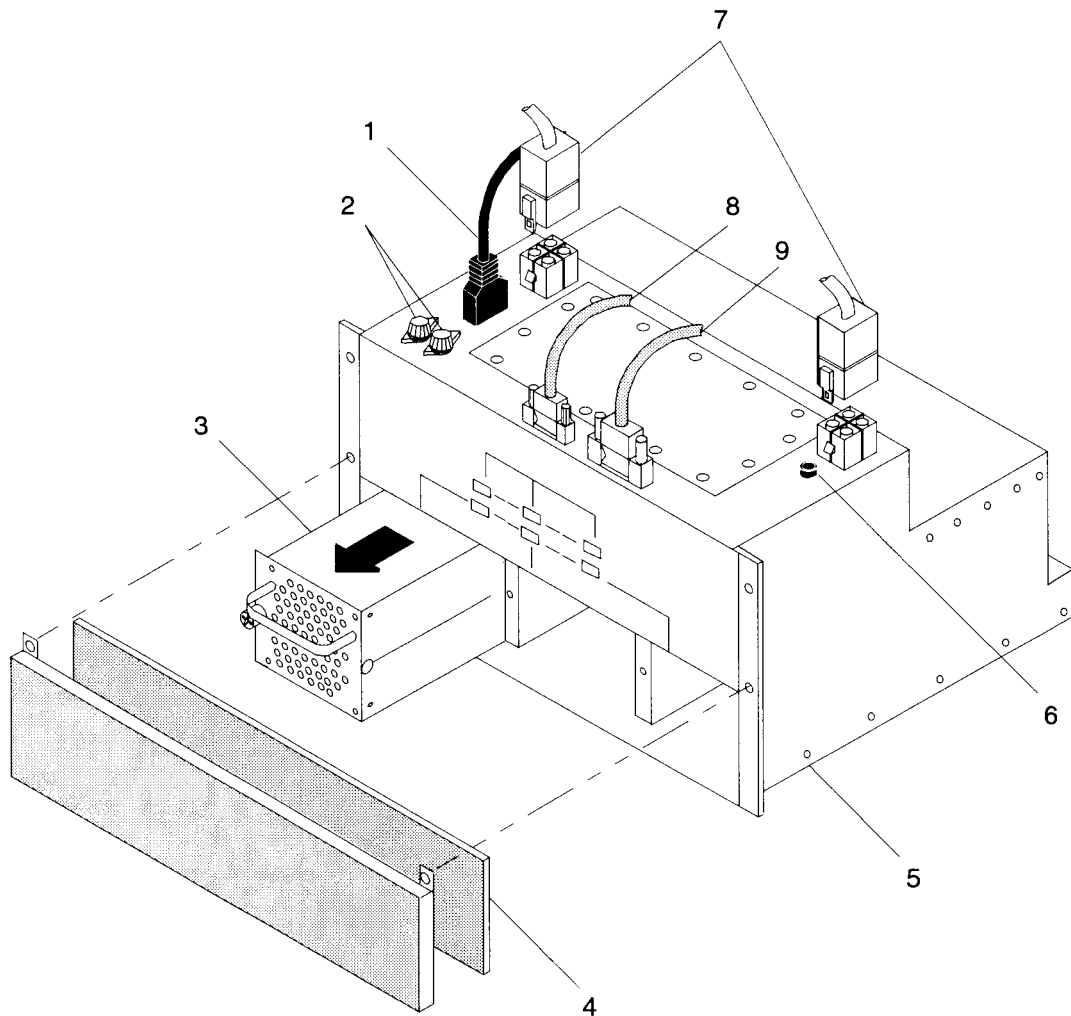

Backplane

Ref. No.	Part Number	Description	Where Used
1	90445200	4 x 4 Backplane Printed Circuit Board Kit	SV1-1A

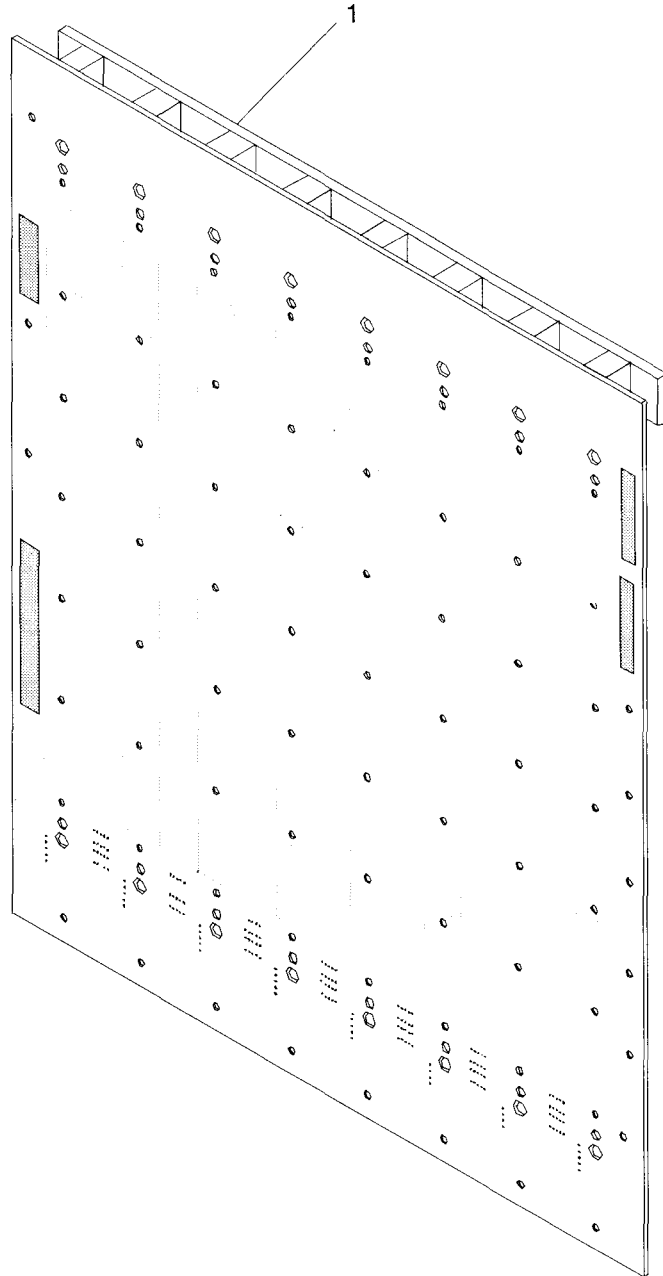

Note: The module side is shown.

Processor Module

Ref. No.	Part Number	Description	Where Used
1	90536300	CPU Module Assembly, w/o Channel Adapter Rev. C	SV1-1A, SV1-1
	90534300	CPU Module Assembly, w/o Channel Adapter Rev. B	SV1-1A, SV1-1
	90535600	CPU Module Assembly, with GigaRing Channel Rev. C	SV1-1A, SV1-1
	90534400	CPU Module Assembly, with GigaRing Channel Rev. B	SV1-1A, SV1-1
	90535700	CPU Module Assembly, with Y1 Channel Adapter Rev. C	SV1-1A, SV1-1
	90534500	CPU Module Assembly, with Y1 Channel Adapter Rev. B	SV1-1A, SV1-1
2	90468500	GigaRing Cable, (Flat)	SV1-1A, SV1-1
	90514700	GigaRing Cable, (Round)	SV1-1A, SV1-1

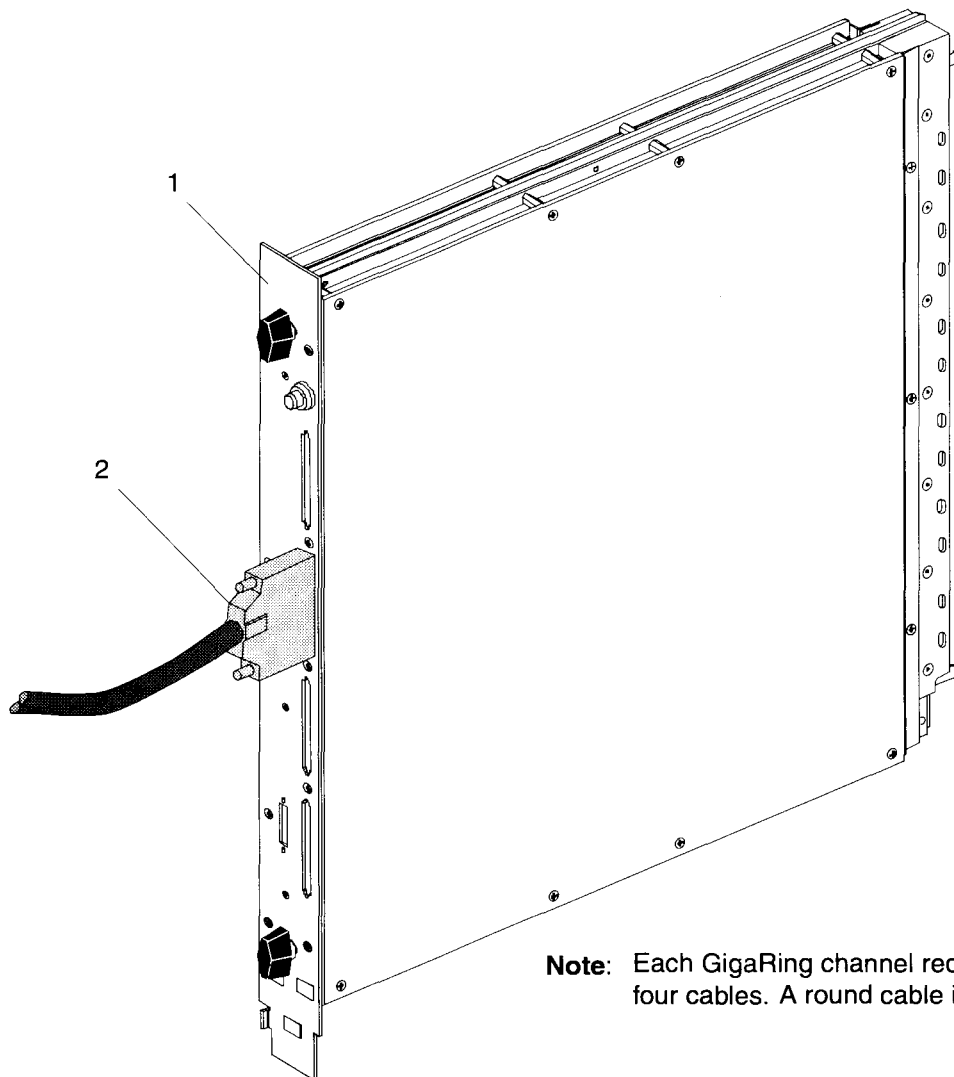

Memory Module

Ref. No.	Part Number	Description	Where Used
1	90373202	Memory Module, (MEM64) PLL	SV1-1A
	90373102	Memory Module, (MEM128) PLL	SV1-1A
	90481100	Memory Module, (MEM256) PLL	SV1-1A
	90481200	Memory Module, (MEM512) PLL	SV1-1A

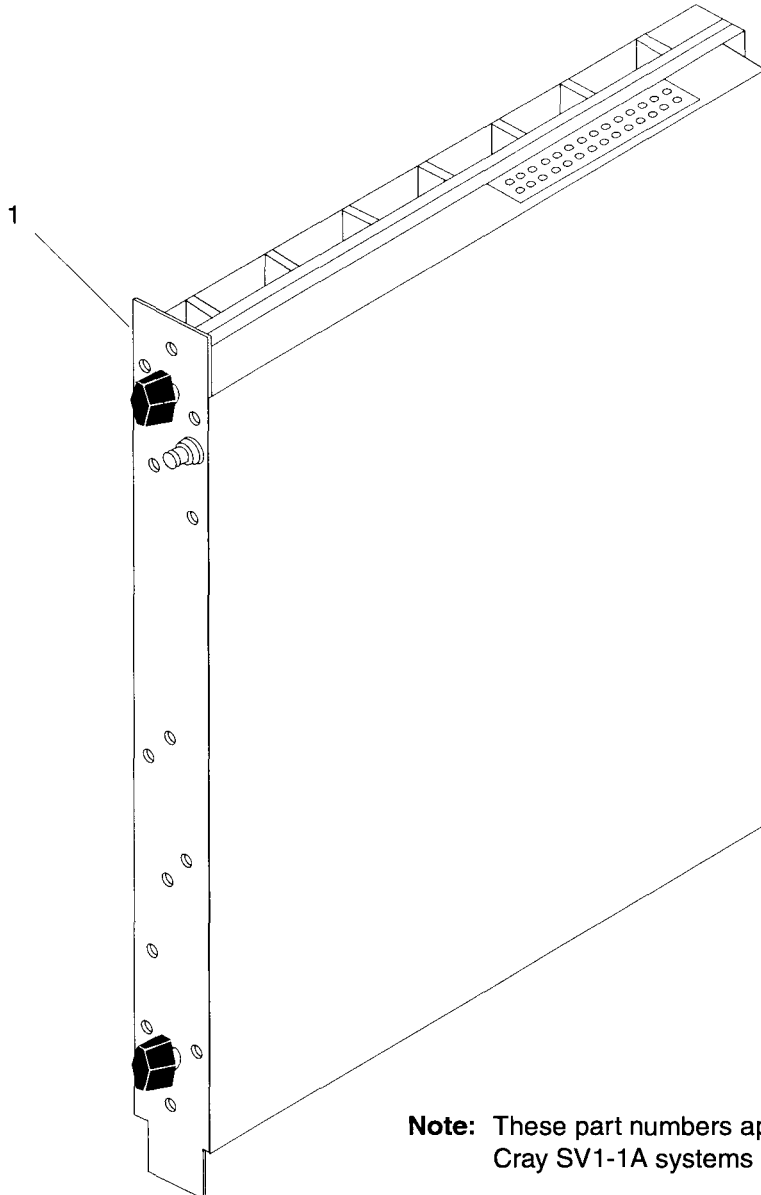

Note: These part numbers apply to Cray SV1-1A systems only.

AC Power Entry Chassis

Ref. No.	Part Number	Description	Where Used
1	90358501	AC Power Entry Chassis Assembly	SV1-1A
2	90350300	CCU to AC Power Entry Sense Cable	SV1-1A
3	90468000	AC Power Entry to I/O Bulkhead Sense Cable	SV1-1A, SV1-1
4	90086603	Power Cord Assembly, North American	SV1-1A, SV1-1
	90097403	Power Cord Assembly, International	SV1-1A, SV1-1
5	90519700	Right Grille Assembly Clip	SV1-1A
6	90519800	Left Grille Assembly Clip	SV1-1A

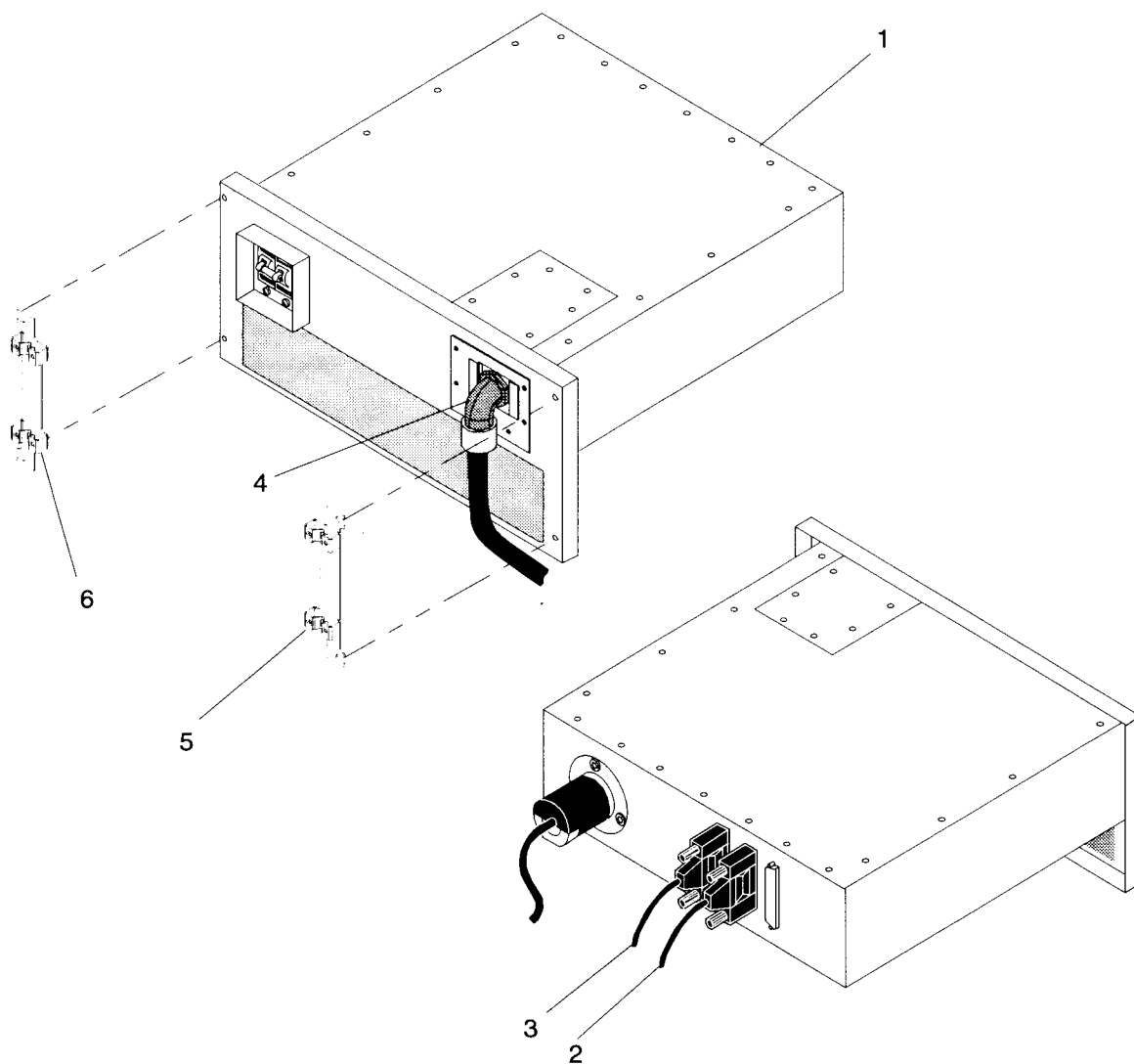

Blower Assembly

Ref. No.	Part Number	Description	Where Used
1	90513600	Blower Assembly	SV1-1A
2	90311701	Fuse, 7 A	SV1-1A
3	90350400	Front-end Power Chassis to Blower Assembly Sense Cable	SV1-1A, SV1-1
4	90307101	Power Cord, 1 m	SV1-1A, SV1-1

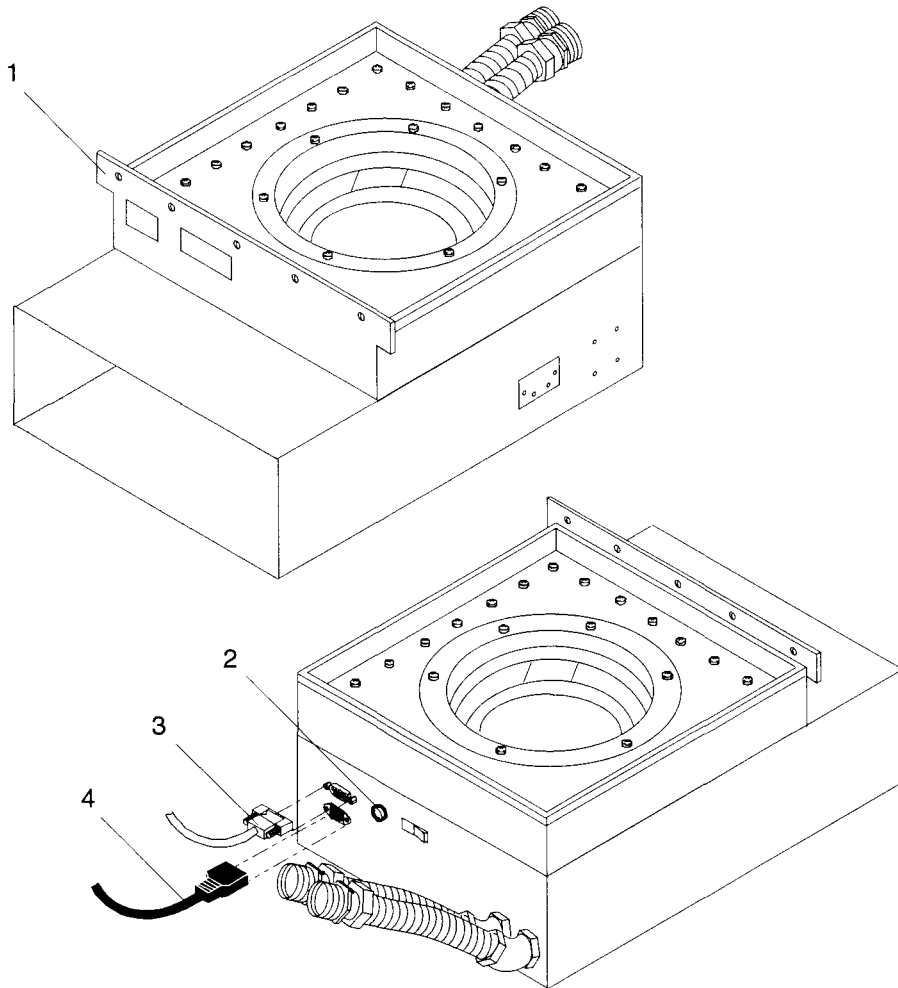

Cray SV1-1 Mainframe Cabinet

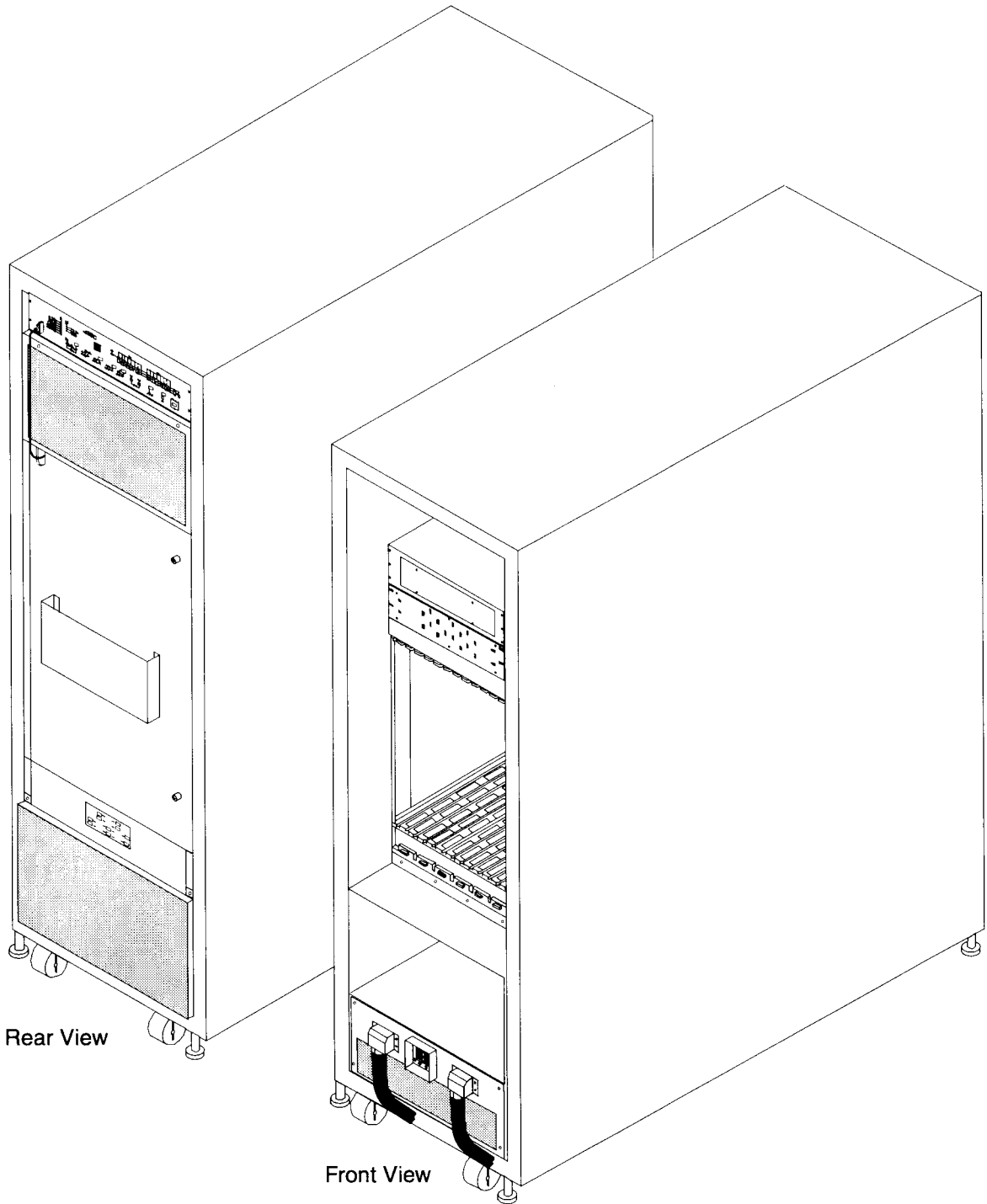

Central Control Unit

Ref. No.	Part Number	Description	Where Used
1	90473600	Central Control Unit with Remote RS-232	SV1-1
2	90526300	CCU to Bezel Cable	SV1-1A, SV1-1
3	90350800	CCU (J1) to Card Cage Midplane Sense Cable	SV1-1
4	90350001	CCU (J2) to Card Cage Midplane Sense Cable	SV1-1
5	90350201	CCU to Front-end Power Sense Cable	SV1-1
6	90350302	CCU to AC Power Entry Sense Cable	SV1-1
7	90350600	Alarm Cable	SV1-1A, SV1-1
8	90472300	CCU to RS-232 Remote Cable	SV1-1A, SV1-1
9	90537900	Serial Port EL-16 Cable	SV1-1A, SV1-1
10	13309000	Adapter, WACS RJ45-DB25	SV1-1A, SV1-1
11	90454000	Battery, 1.2 V	SV1-1A (qty. 4), SV1-1 (qty. 8)

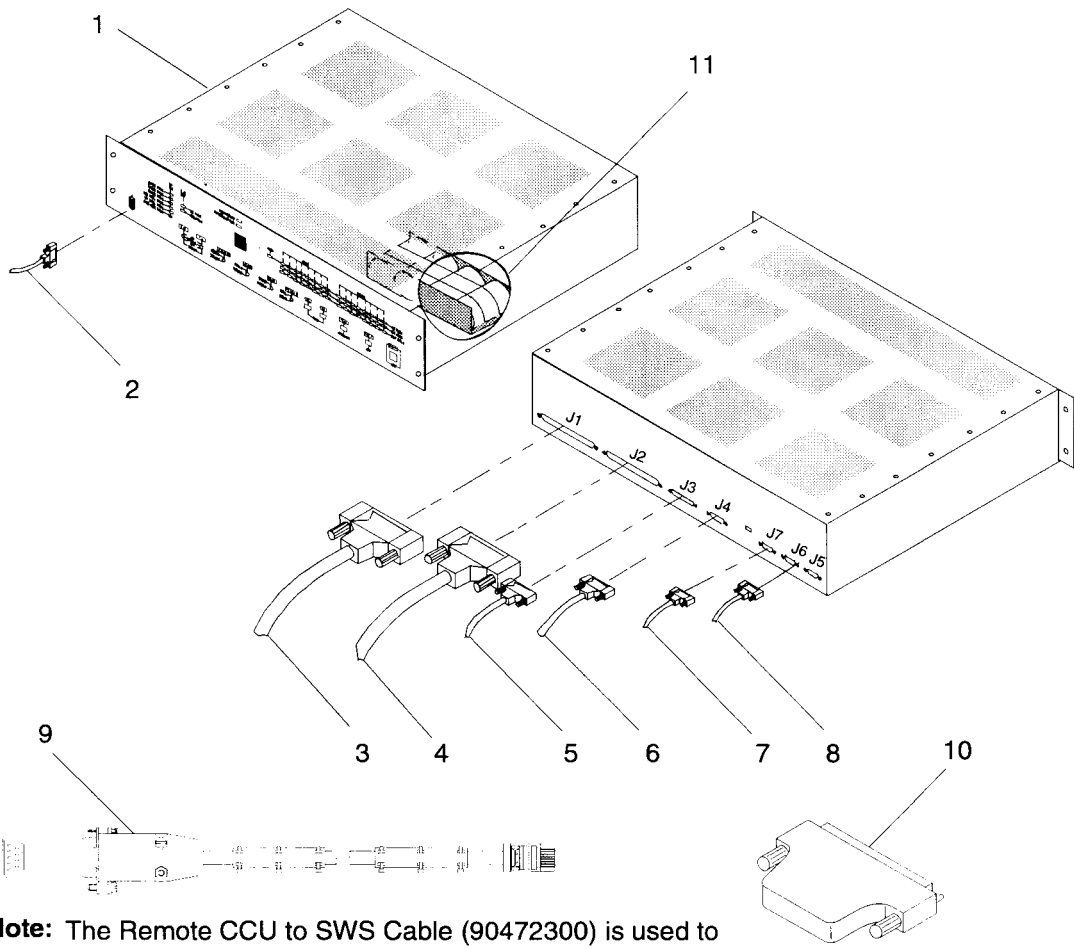

Note: The Remote CCU to SWS Cable (90472300) is used to connect the CCU to the RS-232 remote cable at the I/O bulkhead.

Input Air Filter

Ref. No.	Part Number	Description	Where Used
1	90312400	Input Air Filter	SV1-1A (qty. 1), SV1-1 (qty. 2)

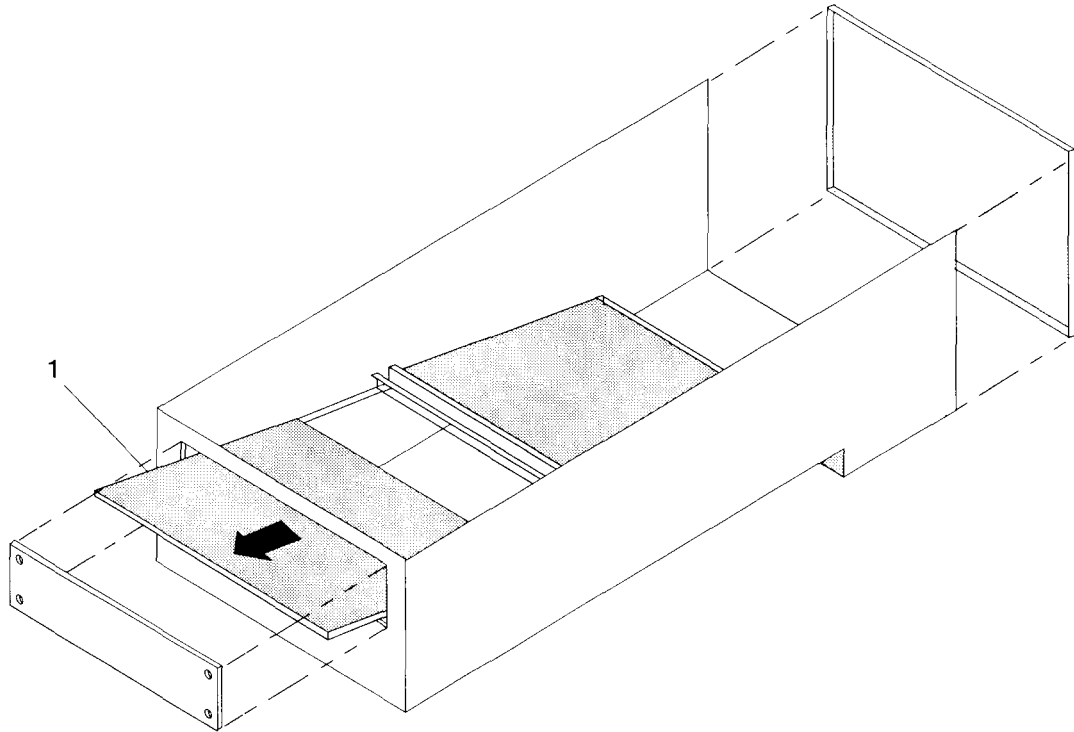

CPU Card Cage

Ref. No.	Part Number	Description	Where Used
1	90350101	Sense Cable	SV1-1A, SV1-1
2	90350901	Sense Cable	SV1-1
3	90400700	8 x 8 Midplane Module Assembly	SV1-1
4	90430000	48 Vdc Midplane Bus Assembly	SV1-1

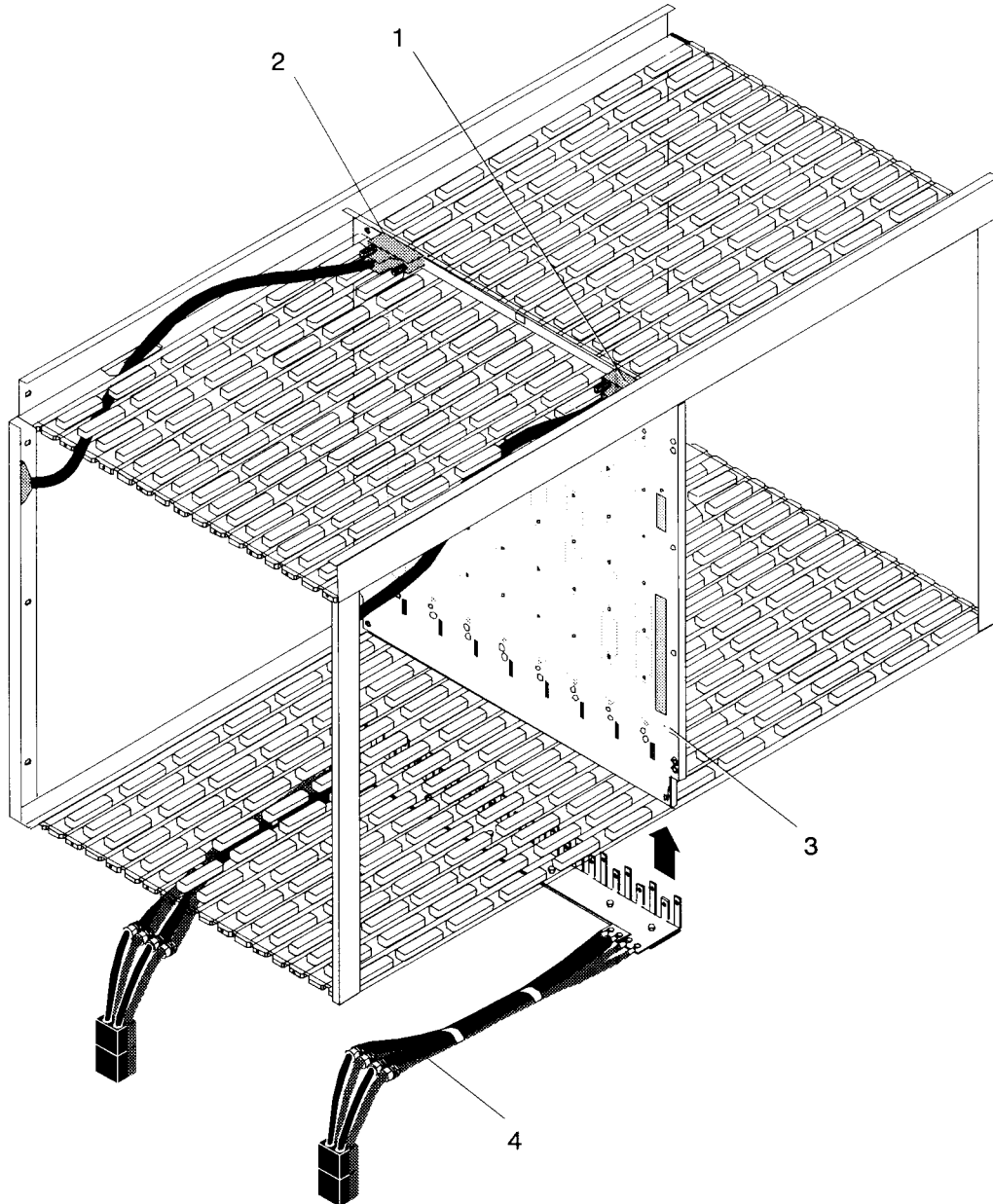

Front-end Power Chassis

Ref. No.	Part Number	Description	Where Used
1	90307101	Power Cord, 1 m	SV1-1A, SV1-1
2	90459600	Fuse, 10 A	SV1-1A, SV1-1
3	90327900	220 Vac/48 Vdc Power Supply	SV1-1A, SV1-1
4	90405700	Power Supply Air Filter	SV1-1
5	90401900	Front-end Power Chassis	SV1-1
6	01134006	Fuse, 1/2 A	SV1-1A, SV1-1
7	90430000	Front-end to CPU Midplane Cable, 48 Vdc	SV1-1
8	90350400	Front-end Power Chassis to Blower Assembly Sense Cable	SV1-1A, SV1-1
9	90350201	CCU to Front-end Power Sense Cable	SV1-1

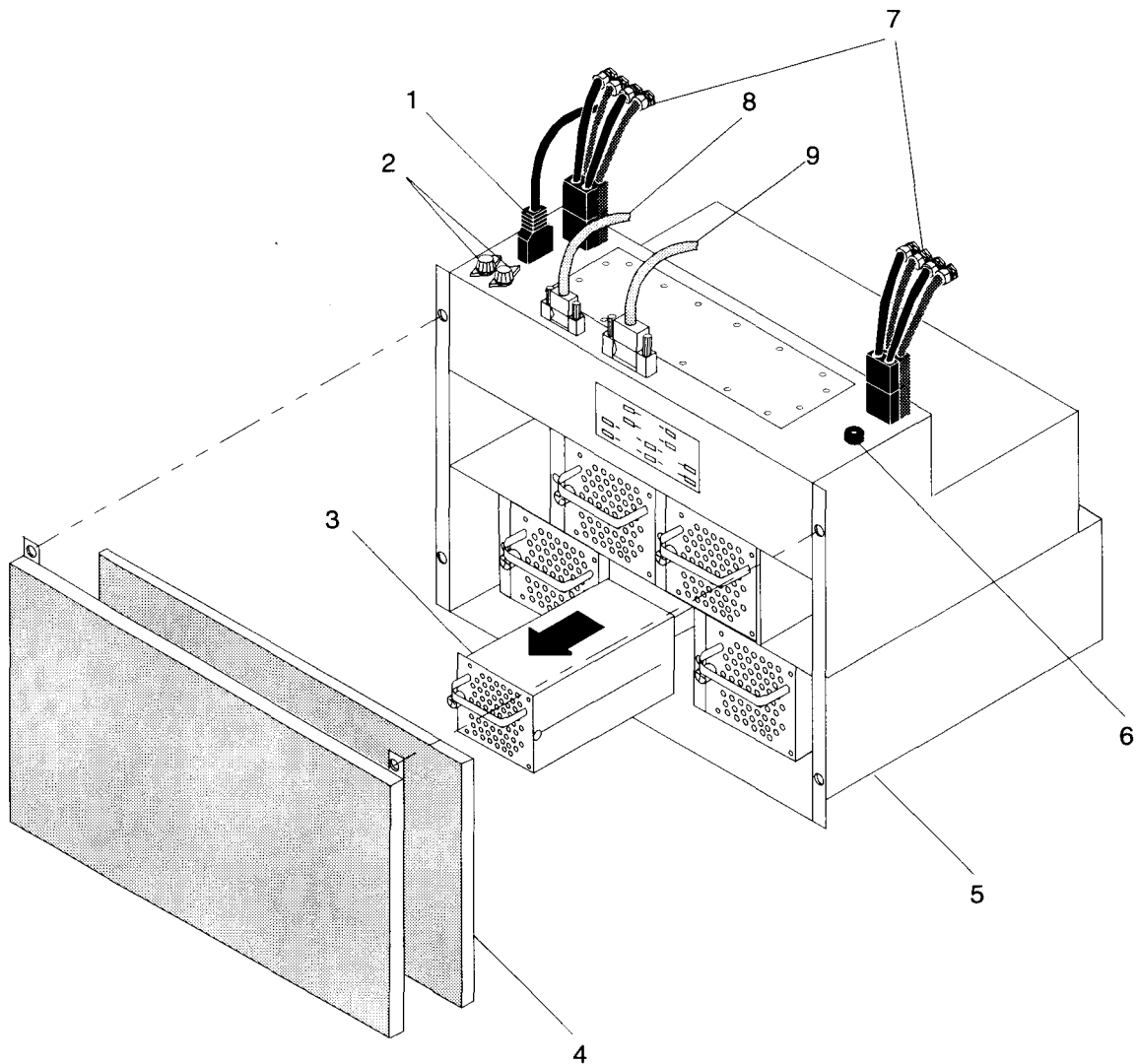

Clock Module

Ref. No.	Part Number	Description	Where Used
1	90536200	Clock Module	SV1-1A, SV1-1

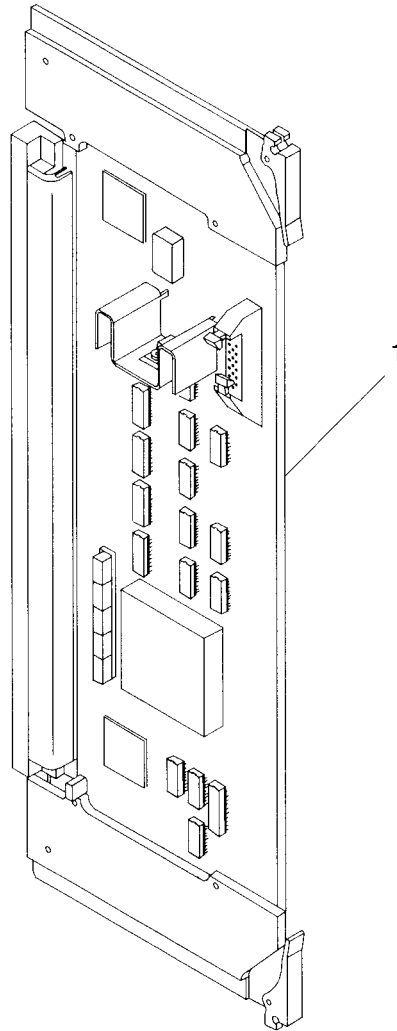

Processor Module

Ref. No.	Part Number	Description	Where Used
1	90536300	CPU Module Assembly, w/o Channel Adapter Rev. C	SV1-1A, SV1-1
	90534300	CPU Module Assembly, w/o Channel Adapter Rev. B	SV1-1A, SV1-1
	90535600	CPU Module Assembly, with GigaRing Channel Rev. C	SV1-1A, SV1-1
	90534400	CPU Module Assembly, with GigaRing Channel Rev. B	SV1-1A, SV1-1
	90535700	CPU Module Assembly, with Y1 Channel Adapter Rev. C	SV1-1A, SV1-1
	90534500	CPU Module Assembly, with Y1 Channel Adapter Rev. B	SV1-1A, SV1-1
2	90468500	GigaRing Cable, (Flat)	SV1-1A, SV1-1
	90514700	GigaRing Cable, (Round)	SV1-1A, SV1-1

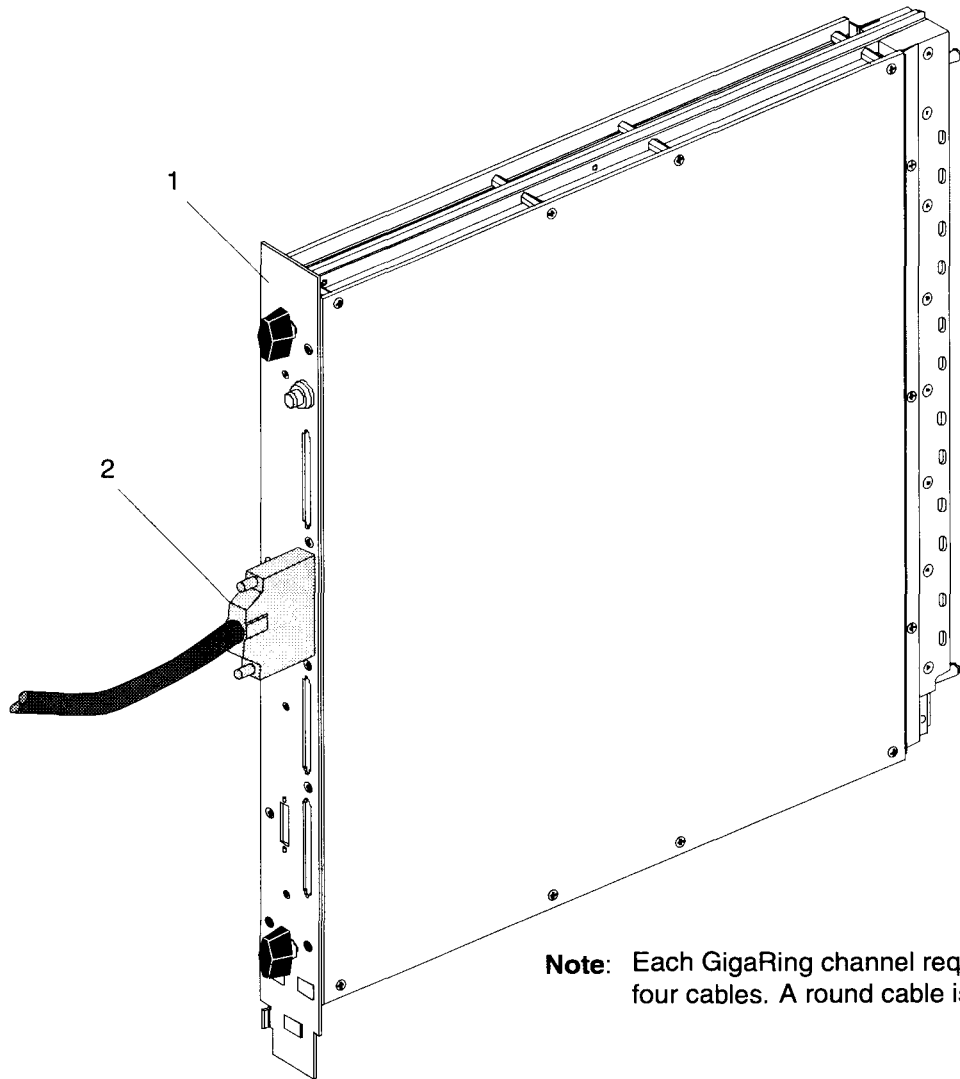

Memory Module

Ref. No.	Part Number	Description	Where Used
1	90424301	Memory Module, (MEM64) PLL	SV1-1
	90424401	Memory Module, (MEM128) PLL	SV1-1
	90481400	Memory Module, (MEM256) PLL	SV1-1
	90481500	Memory Module, (MEM512) PLL	SV1-1

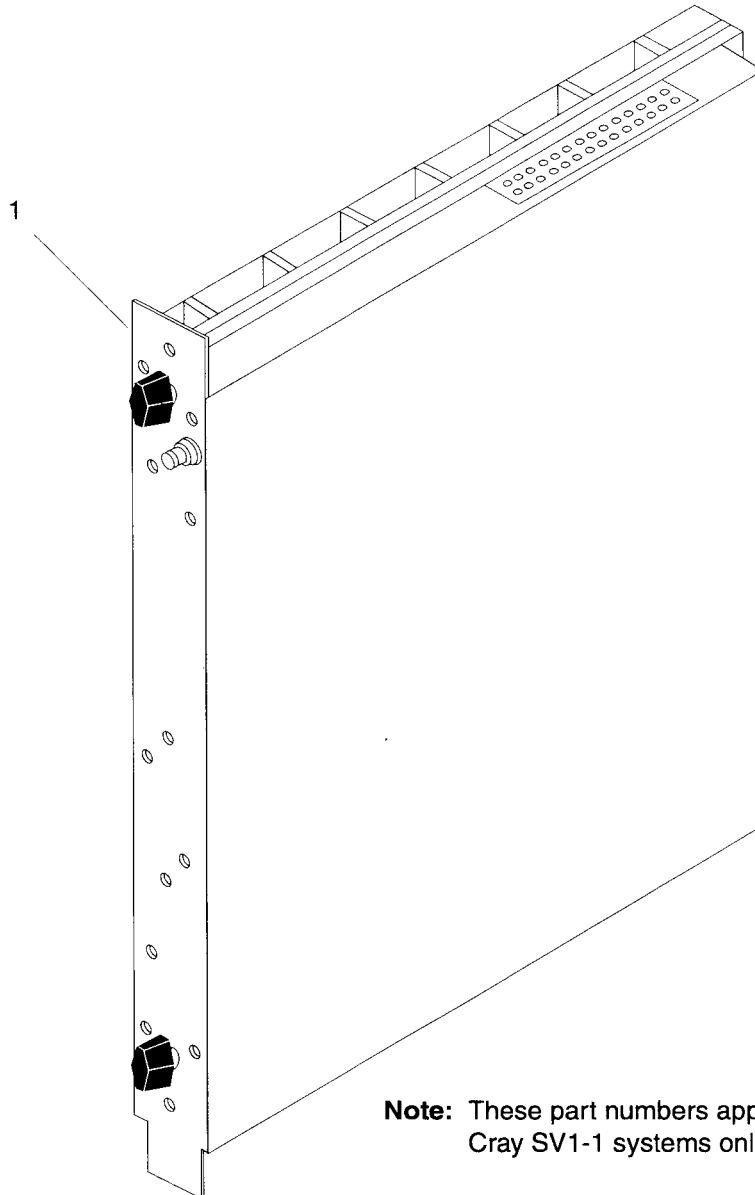

Note: These part numbers apply to Cray SV1-1 systems only.

AC Power Entry Chassis

Ref. No.	Part Number	Description	Where Used
1	90402000	AC Power Entry Chassis Assembly	SV1-1
2	90514200	Left Grille Assembly Clip	SV1-1
3	90525000 *	Center Grille Assembly Clips	SV1-1
4	90514100	Right Grille Assembly Clip	SV1-1
5	90468000	AC Power Entry to I/O Bulkhead Sense Cable	SV1-1A, SV1-1
6	90350302	CCU to AC Power Entry Sense Cable	SV1-1

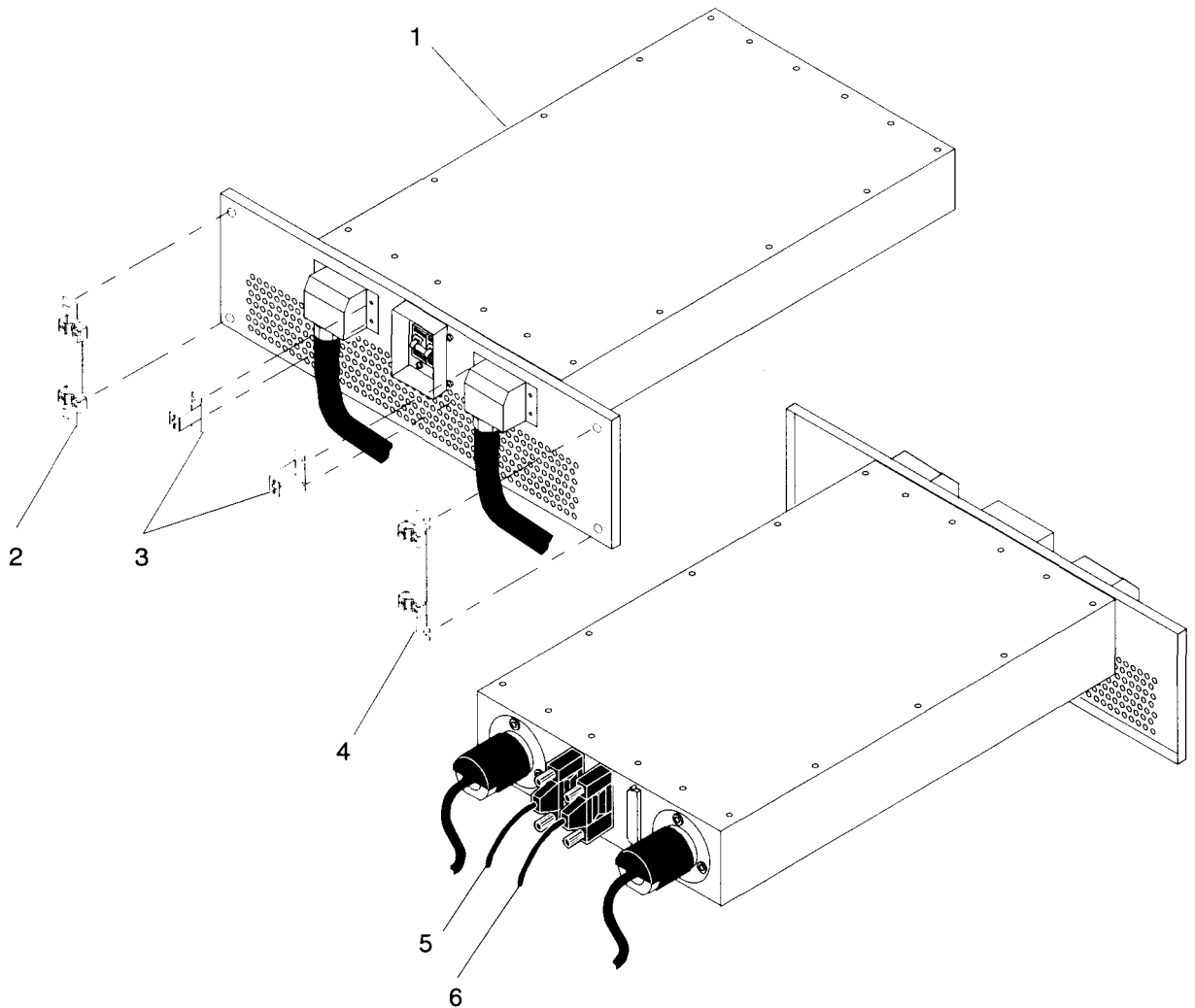

* Not used on Cray SV1-1A systems.

Blower Assembly

Ref. No.	Part Number	Description	Where Used
1	90401800	Blower Assembly	SV1-1
2	90477600	Exhaust Plenum	SV1-1
3	90311700	Fuse, 10 A	SV1-1
4	90307101	Power Cord, 1 m	SV1-1A, SV1-1
5	90350400	Front-end Power Chassis to Blower Assembly Sense Cable	SV1-1A, SV1-1

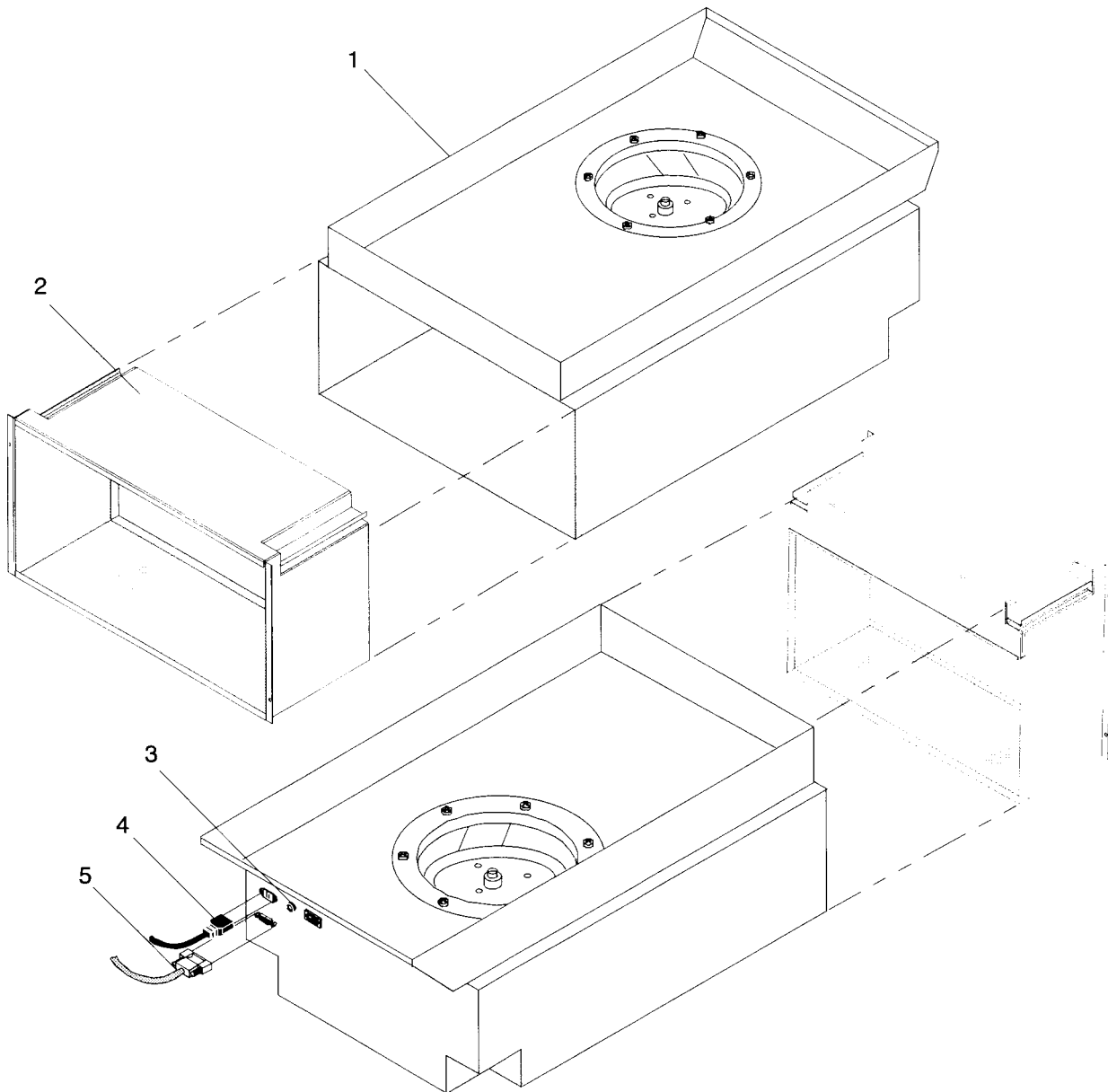

System Support

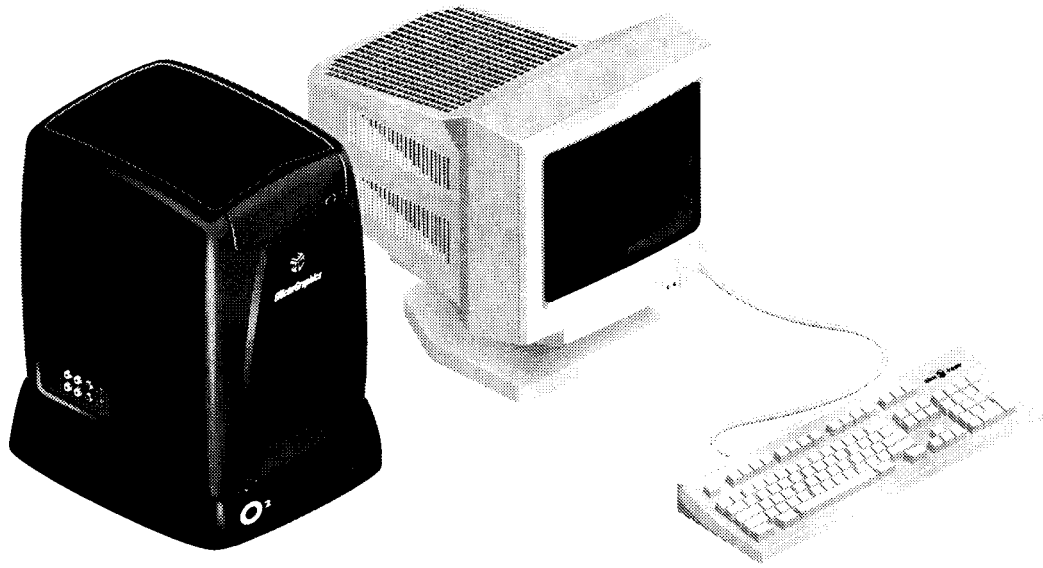

O2 Workstation

Ref. No.	Part Number	Description	Where Used
1	13496410	O2 System Workstation	All systems
2	013-2283-002 *	Tape Drive, External DAT	All systems
3	9210105 *	Board, PCI Ethernet TX	All systems
4	W5-200S-4G64 *	R5K 200SC 4GB/64MB O2	All systems

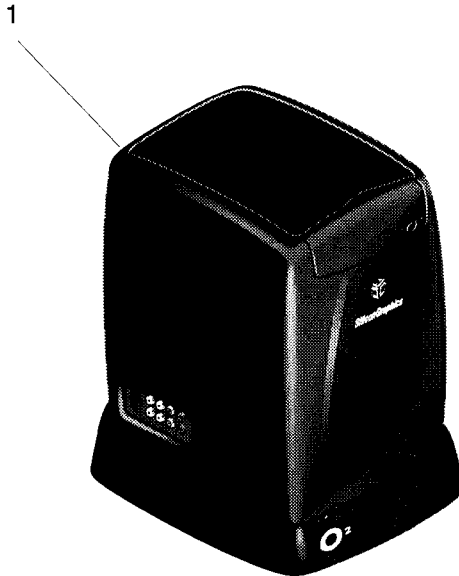

O2 Front View

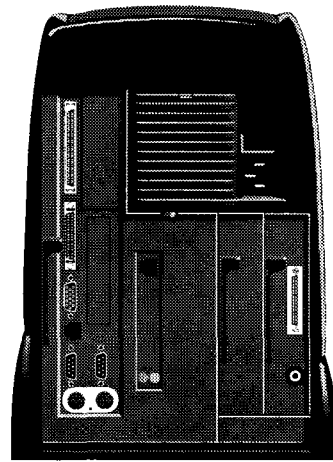

O2 Rear View

* Illustrations are not available.

EtherLite Serial Port Server

Ref. No.	Part Number	Description	Where Used
1	9370112	XCVR EL 16 Port System	All systems

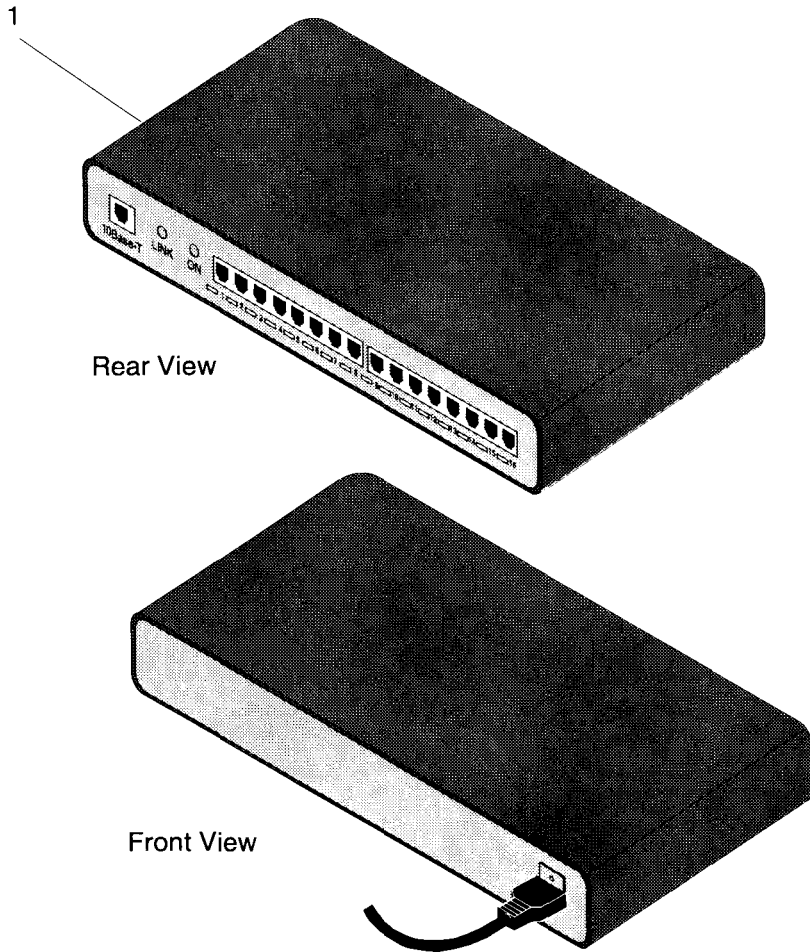

Ethernet Cables

Part Number	Description
13262801	Cable Assembly, 10Base-T Ethernet 50 foot
13296100	Cable Assembly, Ethernet Shielded Crossover
13495101	Adapter, WACS RJ45 to DB-9F
9290154	Cable, EL ENET 10Base-T
060-0057-001	Power Supply, EL AC Adapter

Monitor and Keyboard

Ref. No.	Part Number	Description	Where Used
1	061-0023-001	Monitor, 17 inch N3	All systems
2	062-0002-001	Keyboard, 101 Key PS/2 USA	All systems

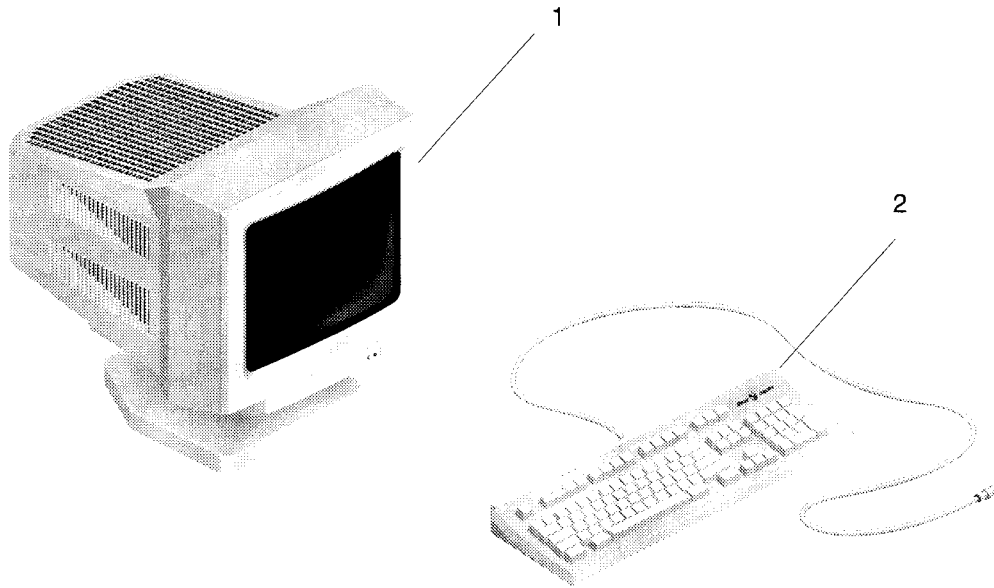

Monitor Cables

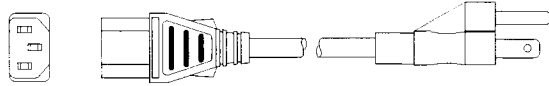
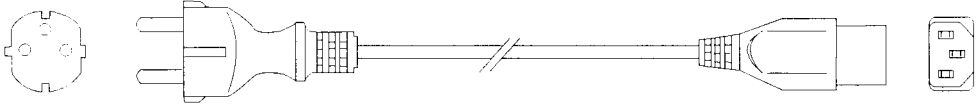
Part Number	Description
9350102	Power Cord, NA (North America) 
9350018	Power Cord, Continental Europe 

Reader Comment Form

Title: Cray SV1™ and SuperCluster® Series
Illustrated Parts Catalog

Number: 108-0204-002

Your feedback on this publication will help us provide better documentation in the future. Please take a moment to answer the few questions below.

For what purpose did you primarily use this document?

Troubleshooting Tutorial or introduction
 Reference information Classroom use
 Other - please explain

Using a scale from 1 (poor) to 10 (excellent), please rate this document on the following criteria and explain your ratings:

Accuracy _____
 Organization _____
 Readability _____
 Physical qualities (binding, printing, page layout) _____
 Amount of diagrams and photos _____
 Quality of diagrams and photos _____

Completeness (Check one and explain your answer)

Too much information Too little information Correct amount

You may write additional comments in the space below. Mail your comments to the address below, fax them to us at +1 715 726 4353, or e-mail them to us at spt@sgi.com. When possible, please give specific page and paragraph references. We will respond to your comments in writing within 48 hours.

NAME _____
JOB TITLE _____
E-MAIL ADDRESS _____
SITE/LOCATION _____
TELEPHONE _____
DATE _____

[or attach your business card]

The logo for SGI (Silicon Graphics International) consists of the lowercase letters 'sgi' in a bold, sans-serif font. A small 'TM' trademark symbol is positioned to the upper right of the 'i'.

Attn: Service Publications and Training
890 Industrial Boulevard
P.O. Box 4000
Chippewa Falls, WI 54729-0078
USA



